

5501T Wait Stations

Description:

Mobile outdoor Ipe (ironwood) cabinet with tall sides and top shelf housing granite counter-top work area, space for POS station, locking sliding doors, and with accessory options for locking roll-down doors, adjustable height shelves and/or drawers, sinks, ice bins, refrigeration, beverages, waste and recycle bins.

Standard Features:

- Solid ipe hardwood construction
- Heavy duty 4"x2" casters
- Locking front casters
- Locking sliding doors
- Storage slot for sliding doors
- Granite counter tops
- Counter-top access grommets

Specifications:

Unit dimensions:

- Length - 55 1/4"
- Width - 31"
- Height (overall) - 64 1/2"
- Height (counter) - 40 3/4"
- Weight - 1100 Lbs.

Crated for shipping dimensions:

- Length - 64"
- Width - 39"
- Height - 74"
- Weight - 1400 Lbs.

Accessories & Options:

- Full width adjustable top shelf
- Partial width adjustable top shelf
- Adjustable internal drawers & shelves
- Ice & Water Fill Station
- Sink
- Self Contained Hot & Cold Water
- Self Contained Cold Water
- Refrigerator
- Cups and Cold Drawers
- Counter top waste bucket with lid
- Counter top waste chute with lid
- Waste / recycle bins
- Roll-down anodized aluminum tambour-style door
- Umbrella Holder
- Swinging doors
- Solid surface material counters



Model 5501TRD-S4-S4-2
Shown with full width adjustable top shelving kit

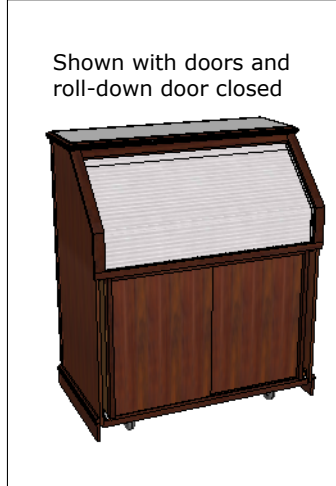

Shown with doors and roll-down door closed

Front View

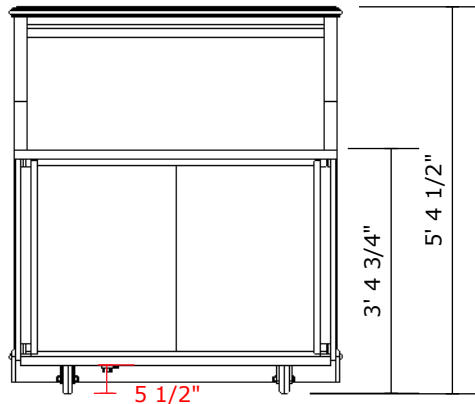

Sliding door storage slots

Top View

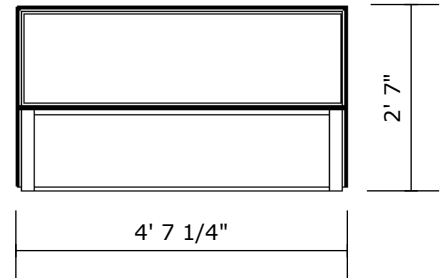

Back View

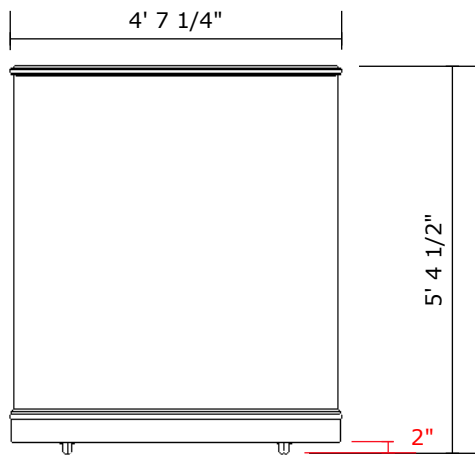

Side View

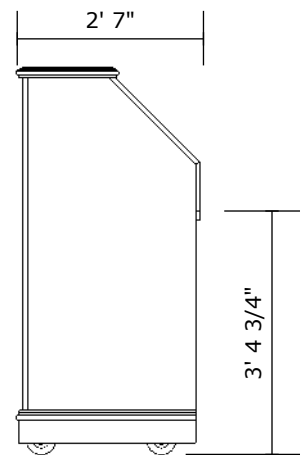

5501T Wait Stations

Configure Model Options

Start with an empty 5501T Wait Station (left) and configure it to meet your needs from the standard modular options below.

Write the module codes for the corresponding position in the SKU # by making the following choices:

- 1) Choose roll-down door or no roll-down door
- 2) Choose position 1 module
- 3) Choose position 2 module
- 4) Choose upper shelf module

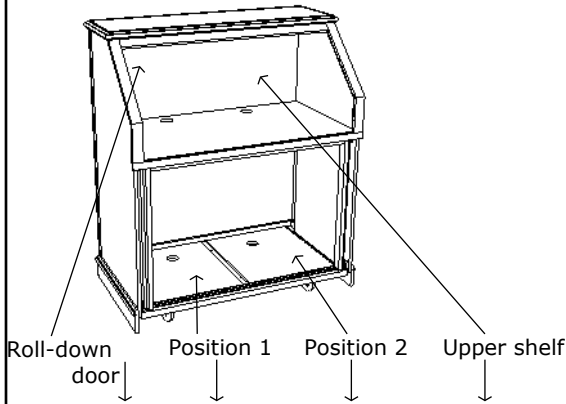

5501T - - - - **Wait Station**

1) Choose roll-down door option

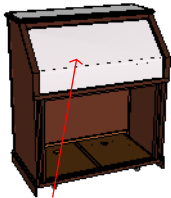

5501TRD- - - -

Roll-down doors

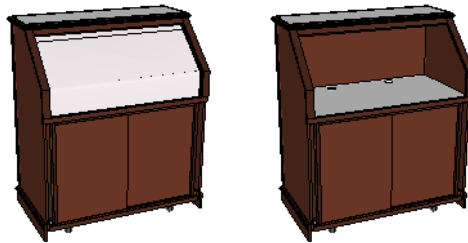

RD - Roll-down door anodized aluminum **ND** - No roll-down door

2) Choose position 1 module

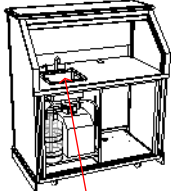

5501TRD-**SHCW**- - -

Configuration Modules

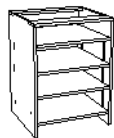

S4 - Shelf module with 4 adjustable shelves

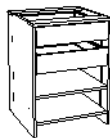

DS - Drawer & shelf with 2 adjustable drawers & 2 adjustable shelves

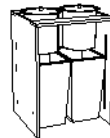

TRB or **TRC** - Recycle and waste bins with counter top buckets (**B**) or chutes (**C**)

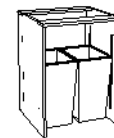

TR - Recycle and waste bins

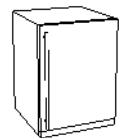

REF - 5.5 cu ft stainless steel refrigerator - Works best in Position 2

3) Choose position 2 module

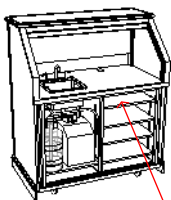

5501TRD-SHCW-**S4**- - -

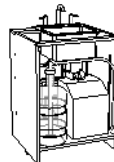

SHCW - Sink with self-contained hot and cold water (**HCW**)

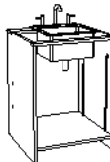

S - Sink

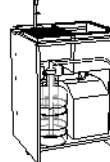

IWCW - Ice & water fill station with self-contained cold water (**CW**)

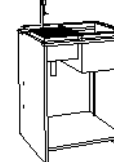

IW - Ice & water fill station

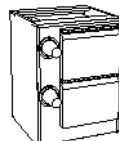

CD - Ice cooled stainless steel cold drawers (2) & cup dispensers (2)

4) Choose upper shelf

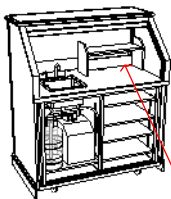

5501TRD-SHCW-S4-**1R**

Upper Shelf



0 - No shelf



1L - Partial shelf left



1R - Partial shelf right



2 - Full shelf

5501T Wait Stations

Pricing

Item Code	Description
5501T	Tall 55" Wait Station
RD	Anodized aluminum roll-down door
ND	NO roll-down door
S4	Shelf module
DS	Drawers & shelves module
TRB	Trash & recycle bins with countertop buckets
TRC	Trash & recycle bins with countertop chutes
TR	Trash & recycle bins
S	Sink
SHCW	Sink with self-contained hot & cold water
IW	Ice & water fill station
IWCW	Ice & water fill station with self-contained cold water
CD	Cup dispensers (2) & cold drawers (2)
REF	5.5 cu. Ft. stainless steel refrigerator
SOL **	Upgrade to solid surface counters
SWD **	Upgrade to swing doors
0	No upper shelf
1L	Partial upper shelf - Left
1R	Partial upper shelf - Right
2	Full upper shelf
VC **	Vinyl Cover
UB **	Market Umbrella Holder Bracket

** Add code to end of item SKU #

Mechanicals Access

All wait stations come with a 15 Amp 120V GFCI outlet with 9' cord and NEMA 5-15 plug type in the cabinet.

Counter tops have 2" access grommets for electric and data cables. Access grommets are provided in the base of all units at fixed intervals for easy access to electrical, data and plumbing connections. End user is responsible for final connections.

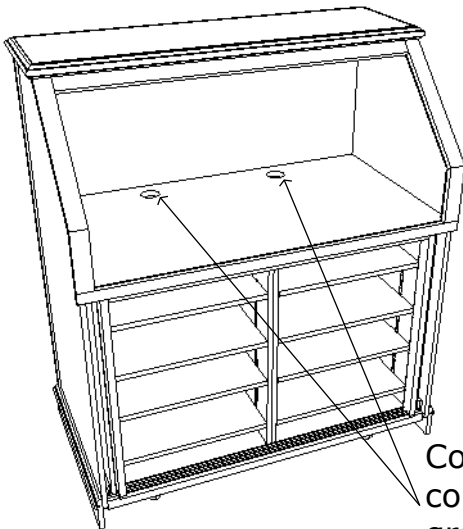

Counter top
cord drop
grommets

Bottom View

Front

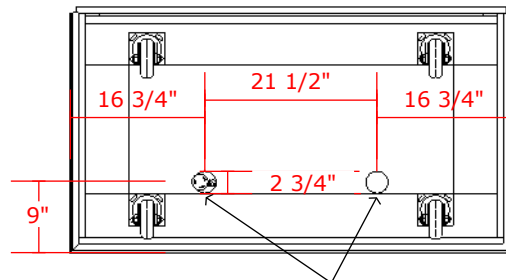

Mechanicals Access Grommets

Shop Drawings - OK for production

Approved _____

Date _____